

APPLICATION

Plunger hydraulic cylinder transfers accumulated in a working liquid pressure energy into mechanical energy which puts the piston in reciprocating motion.

Plunger hydraulic cylinder transfers accumulated in a working liquid pressure energy into mechanical energy which puts the piston in reciprocating motion.

DIAGRAM

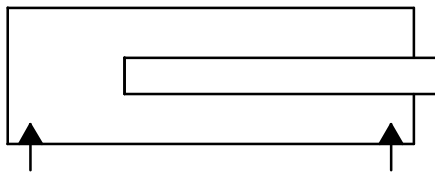

TECHNICAL DATA

Working fluid	hydraulic fluid (viscosity 10 - 450 mm ² /s)
Nominal pressure	20 MPa
Required fluid filtration	16µm
Operating temperature	-30 do 80°C
Max. rod speed	0,5 m/s
Efficiency	> 0,9
Piston rod coating	chrome

OVERALL DIMENSIONS

Type 1, 2

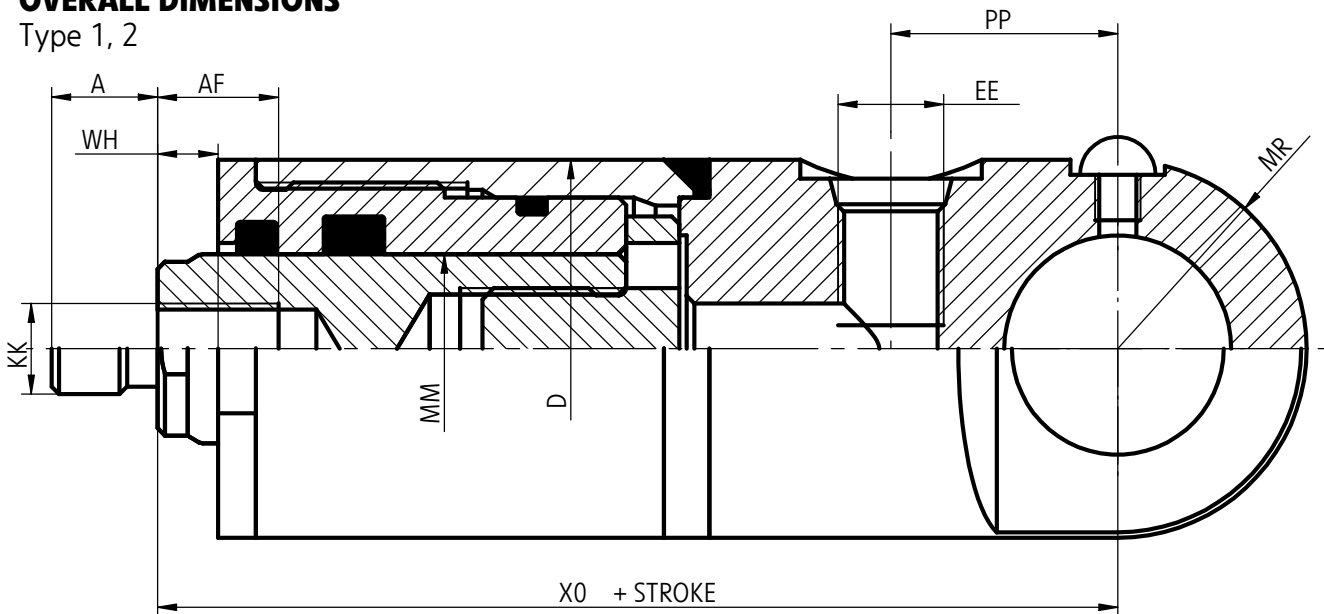

Type 1

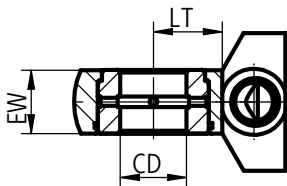

Type 2

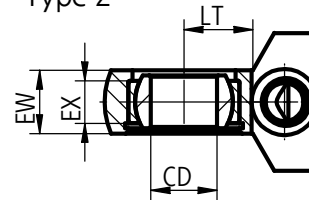

Metric port - PN/M-73101
Inch port - DIN 3852

MM	25	32	40	50	63	80								
A	14	16	18	20	22	30								
AF	16	22	20	22	28	34								
CD	16	20	25	30	35	40								
D	48	57	60	82,5	95	114								
EE	M	M14x1,5	M14x1,5	M16x1,5	M16x1,5	M22x1,5	M27x2							
	G	G 1/4"	G 1/4"	G 1/2"	G 1/2"	G 1/2"	G 3/4"							
EW	12	20	24	26	31	32								
EX	14	16	20	22	25	28								
KK	M12x1,5	M16x1,5	M16x1,5	M22x1,5	M27x2	M33x2								
LT	16	22	26	28	36	45								
MR	25	28,5	32	41	52,5	64								
PP	30	34	38	58	56	65								
WH	8	15	26	29	44	15	14	49						
XO	127	137	132	147	157	195	185	210	225	192	207	227	262	302
	200	400	100	250	630	1250	125	400	1600	200	500	1250	400	1250
Stroke up to	200	400	100	250	630	1250	125	400	1600	200	500	1250	400	1250

EE M for metric port
EE G for inch port

HOW TO ORDER

UCN	+		+	20	+		+		+	*
Plunger hydraulic cylinder										
Mounting: swivel bearing = 1 spherical bearing = 2										
Ports: metric thread = M inch thread = G										
Piston rod end: external thread = Z internal thread = W										
Nominal pressure MPa										
Series number X5 =X5 (X5-X9) installation and connection dimension unchanged										
Plunger diameter against a table										
Plunger stroke										
Further requirements to be added in text (to agree with manufacturer)										-XXXX

Coding example:
UCN1-MZ-20-X5-80-250

For special requirements please contact the manufacturer.

PONAR Wadowice S.A.
ul. Wojska Polskiego 29
34-100 Wadowice
tel. +48 33 488 21 00
fax. +48 33 488 21 03
www.ponar-wadowice.pl

